

# 上仪 南浦 专注温度测量与控制

名称	型号	图形	分度号	温度范围	页码
普通热电偶 内芯	WRN-010 WRE-010 WRM-010 WRJ-010		K E N J	0~1300 0~800 0~1300 0~750	7
铂铑热电偶 内芯	WRR-010 WRP-010 WRQ-010				7
小铂铑热电偶	WRR-100 WRP-100 WRQ-100		B S R	0~1800 0~1600 0~1600	8
铂铑热电偶	WRR-130 WRP-130 WRQ-130				8
无固定式	WRN-130 WRE-130 WRM-130 WRJ-130				12
固定螺纹式	WRN-230 WRE-230 WRM-230 WRJ-230				13
活动法兰式	WRN-330 WRE-330 WRM-330 WRJ-330				14
固定法兰式	WRN-430 WRE-430 WRM-430 WRJ-430		K E	0~1300 0~800	15
整体打孔锥形 保护管式	WRN-630 WRE-630 WRM-630 WRJ-630		N J	0~1300 0~750	16
活动螺纹式	WRN-730 WRE-730 WRM-730 WRJ-730				13
直角式	WRN-530 WRE-530 WRM-530 WRJ-530				15

# 装配式热电偶

## Assembly Thermocouple

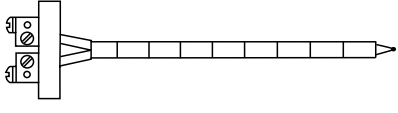
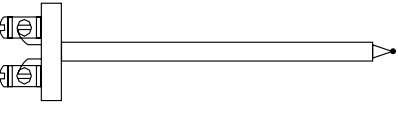
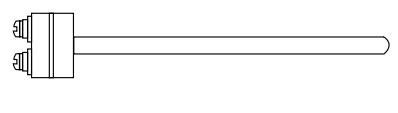
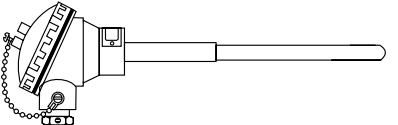
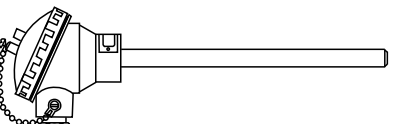
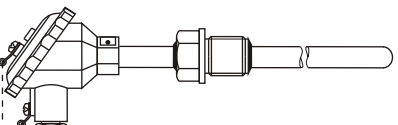
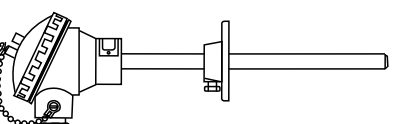
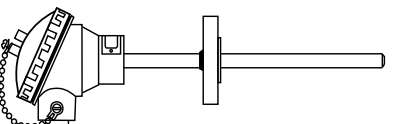
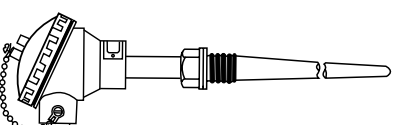
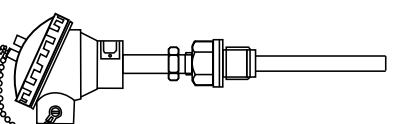
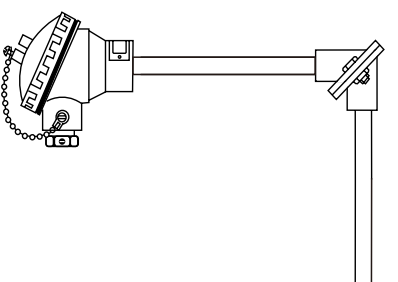

工业用装配式热电偶作为测量温度的传感器，通常和显示仪表、记录仪表、调节器、PLC和DCS系统配套使用。它可以直接测量各种生产过程中从0℃~1800℃范围内的液体、蒸汽和气体介质以及固体的表面温度。

我公司严格根据国家规定，生产符合IEC国际标准分度号的铂铑30—铂铑6、铂铑10—铂、镍铬—镍硅、镍铬硅—镍硅镁、镍铬—铜镍、铜—铜镍、铁—铜镍等形式热电偶，符合JB/T9238-1999标准。

As a sensor for measuring temperature, industrial assembly thermocouple are usually compatible with display instrument, recording instrument, actuator, PLC and DCS system. It can be used to measure the surface temperature of liquid, steam and gas mediums and solid from 0℃-1800℃ during industrial production.

The thermocouples, such as Rhodium Platinum30-Rhodium Platinum6, Rhodium Platinum10-Platinum, Nickel-chromium-nisiloy, Nickel-Chromium-Silicon-Nickel-Chromium-Magnesium, Nickel-Chromium-Cupronickel, Ferrum-cupronickel and Cuprum-cupronickel, produced by our company based on the national stipulation are in accordance with the IEC International Standard Graduation Mark and JB/T9238-1999 Standard.

### 热电偶测温原理 Temperature measurement principle of the thermocouple

热电偶是通过测量其热电势来实现测温的，其两热电极是由两种成份不同的均质导体一端相互连接构成的感温元件。在由两种导体组成的闭合回路中，如果两端点的温度不同，则回路中就会产生一定大小的热电势。其热电势的大小只与导体材料的性质以及两端点的温差有关，同导体的截面积和长度无关。

如下图，选用两种不同的金属或合金丝A、B称为热电极，焊接的一端称为测量端，连接显示仪表的一端称为参比端，当测量端和参比端温度不同时，就会产生热电势 $E_{AB}(t, t_1)$ 。当 $t_1 = 0^\circ\text{C}$ 时则有：

$$E_{AB}(t, 0) = E_{AB}(t) = f(t)$$

The temperature measuring for thermocouple is achieved through measuring its thermoelectrical potential. Its two thermodes are temperature sensing elements made of equivalent conductors with two different compositions and one connected ends. In the closed loop made of two kinds of conductors, if different temperature arises on the two endpoints, then a certain thermoelectrical potential will be created. The thermoelectrical potential intensity is not related to the sectional area and length of copper conductor but the properties of conductor materials and the temperature of their two endpoints.

Select two different kinds of wire or alloy wire A and B as thermodes, of which, the welded end is referred to as temperature measurement end, the one connected with the indicating instrument is referred to as reference junction. When the temperature of both ends differs from each

$$E_{AB}(t, 0) = E_{AB}(t) = f(t)$$

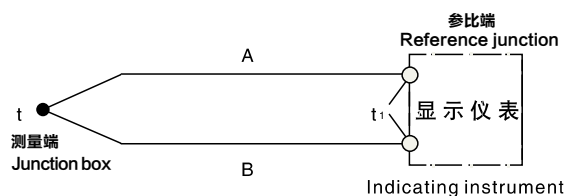

热电偶测温原理

Temperature measurement principle of the thermocouple

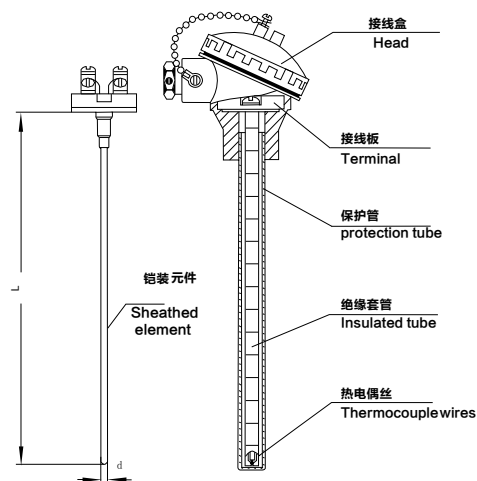

WR□K-101 热电偶基本结构

Basic structure of the thermocouple

## 热电偶特性 Characteristic of the thermocouple

热电偶具有测温范围广，热电性能稳定，结构简单，信号可远传，价格低等优点。

The thermocouple has such advantages as wide scope of temperature measurement, stable thermoelectric property, simple structure, signal available for long distance and low price.

根据不同温区和使用环境的要求，须选用不同型号的热电偶材料和保护管。

It is necessary to select thermocouple materials and protection tube of different type in accordance with requirements of different temperature ranges and application environments.

我公司生产的工业热电偶符合JB/T9238-1999《工业热电偶技术条件》，GB/T18404-2001《铠装热电偶电缆及铠装热电偶》（dit. IEC61515:1995），GB/T16839-1997《热电偶分度表及允差》（dit. IEC584-1 and IEC584-2）等标准。

The industrial thermocouples produced by our company comply with some standards such as JB/T9238-1999 Technical Specification of Industrial Thermocouple, GB/T18404-2001 Sheath Thermocouple Cable and Sheath Thermocouple (dit. IEC61515:1995), GB/T16839-1997 Reference Tables and Tolerances of Thermocouple (dit. IEC584-1 and IEC584-2).

## 主要技术指标 Key technical indexes

### 热响应时间 Thermal response time

在温度出现阶跃变化时，热电偶的输出变化至相当于该变化的50%，所需要的时间称为热响应时间，用 $\tau_{0.5}$ 表示。实验介质通常为水。

When the temperature shown step changes, the output variation of the thermocouple shall be at least equivalent to 50% of the variation, and the time that needs is thermal response time, denoted as  $\tau_{0.5}$ . The experimental medium often is water.

### 热电偶公称压力 Nominal pressure of thermocouple

一般是指在室温情况下保护管所能承受的静态外压而不破损泄漏。实际上，允许工作压力不仅与温度、保护管材料、直径壁厚有关，还与其结构形式、安装方法、置入深度以及被测介质的流速和种类等有关。

It usually indicates the static external pressure the protection tube is capable of bearing under the room temperature while the protection tube does not break. In fact, the safe working pressure is not only related to temperature, materials of protection tube and wall thickness of diameters, but also related to structural configuration, assembling method, placed depth and the flow rate and type of the mediums to be measured.

**热电偶最小置入深度 Minimum inset depth of thermocouple**

应不小于其保护管外径的8~10倍（特殊产品例外）。

The minimum placed depth shall not be less than 8~10 times of the external diameter of its protection tube (Excluding special products).

**热电偶的绝缘电阻（常温） Insulation resistance of thermocouple (normal temperature)**

常温绝缘电阻的试验电压为直流500V ± 50V。测量常温绝缘电阻的大气条件为：温度15~35℃，相对湿度45%~75%，大气压力86~106KPa。

The experimental voltage of insulation resistance at normal temperature is DC 500V ± 50V. The atmospheric condition for measuring normal-temperature insulation resistance is 15~35℃, while the relative humidity is 45%~75% and the atmospheric pressure is 86~106KPa.

a 对于长度超过1米的热电偶它的常温绝缘电阻与其长度的乘积应 $\geq 100M\Omega$ 。

既： $R_r \cdot L \geq 100M\Omega \cdot m > 1m$

式中：L 热电偶的长度，m。

a. For the thermocouple longer than 1m, the product of its normal-temperature insulation resistance and length shall not be less than 100 MΩ. That is,  $R_r \cdot L \geq 100M\Omega \cdot m > 1m$ .

Where: L is the length of the thermocouple, m.

b 对于长度等于或不足1米的热电偶，它的常温绝缘电阻值应不小于100MΩ。

b. For the thermocouple not longer than 1m, its normal-temperature insulation resistance shall not be less than 100MΩ.

**热电偶上限温度绝缘电阻 Insulation resistance at upper limit temperature**

测量条件为：被加热的长度为300mm或其总长的50%。试验电压为 $10 \pm 1 (V \cdot DC)$ 。

Measuring condition: The heated length shall be 300mm or 50% that of the overall length. The test voltage shall be  $10 \pm 1 (V \cdot DC)$ .

热电偶的上限温度绝缘电阻应不小于下表规定：

The insulation resistance at upper limit temperature shall not less the specifications shown in the table below:

上限温度 $t_m$ (°C) Upper limit temperature	试验温度 $t_m$ (°C) Experimental temperature	电阻值 $M\Omega$ Resistance value
$100 \leq t_m < 300$	$t = t_m$	10
$300 \leq t_m < 500$	$t = t_m$	2
$500 \leq t_m < 850$	$t = t_m$	0.5
$850 \leq t_m < 1000$	$t = t_m$	0.08
$1000 \leq t_m < 1300$	$t = t_m$	0.02
$t_m > 1300$	$t = 1300$	0.02



热电偶类型、测量范围、等级和允差 Type, measuring range, class and tolerance (GB/T16839.2)

类别 Model	代号 Code	分度号 Graduation Mark	测量范围(°C) Measuring rang	精度 Accuracy	允差 $\Delta t(^{\circ}\text{C})$ Tolerance
铂铑30-铂铑6 Rhodium Platinum30-Rhodium Platinum6	WRR	B	600~1700	2	$\pm 1.5$ 或 $\pm 0.25\%   t  $ $\pm 1.5$ or $\pm 0.25\%   t  $
铂铑10-铂 Rhodium Platinum10-Platinum	WRP	S	0~1600	1	$\pm 1$ 或 $\pm [1+0.3\%(t-1100)]^{\circ}\text{C}$ $\pm 1$ or $\pm [1+0.3\%(t-1100)]^{\circ}\text{C}$
铂铑10-铂 Rhodium Platinum13-Platinum	WRQ	Q	0~1600	1	$\pm 1$ 或 $\pm [1+0.3\%(t-1100)]^{\circ}\text{C}$ $\pm 1$ or $\pm [1+0.3\%(t-1100)]^{\circ}\text{C}$
镍铬-镍硅 Nickel-chromium-nisiloy	WRN	K	-40~+1000	1	$\pm 1.5$ 或 $\pm 0.4\%   t  $ $\pm 1.5$ or $\pm 0.4\%   t  $
			-40~+1200	2	$\pm 2.5$ 或 $\pm 0.75\%   t  $ $\pm 2.5$ or $\pm 0.75\%   t  $
镍铬硅-镍硅镁 Nickel-Chromium-Silicon-Nickel-silicon-magnesium	WRM	N	-40~+1000	1	$\pm 1.5$ 或 $\pm 0.4\%   t  $ $\pm 1.5$ or $\pm 0.4\%   t  $
			-40~+1300	2	$\pm 2.5$ 或 $\pm 0.75\%   t  $ $\pm 2.5$ or $\pm 0.75\%   t  $
镍铬-铜镍 nickel-chromium-cupronickel	WRE	E	-40~+800	1	$\pm 1.5$ 或 $\pm 0.4\%   t  $ $\pm 1.5$ or $\pm 0.4\%   t  $
			-40~+900	2	$\pm 2.5$ 或 $\pm 0.75\%   t  $ $\pm 2.5$ or $\pm 0.75\%   t  $
铁-铜镍 Ferrum-cupronickel	WRJ	J	-40~+750	1	$\pm 1.5$ 或 $\pm 0.4\%   t  $ $\pm 1.5$ or $\pm 0.4\%   t  $
				2	$\pm 2.5$ 或 $\pm 0.75\%   t  $ $\pm 2.5$ or $\pm 0.75\%   t  $
铜-铜镍 Cuprum-cupronickel	WRT	T	-40~+350	1	$\pm 0.5$ 或 $\pm 0.4\%   t  $ $\pm 0.5$ or $\pm 0.4\%   t  $
				2	$\pm 1$ 或 $\pm 0.75\%   t  $ $\pm 1$ or $\pm 0.75\%   t  $

注：(1) t为实测温度值。(2) 测量范围仅指偶丝。(3) 同栏两个允差值中取较大者。

Note: (1) t is the measured temperature value. (2) The measuring range is used only for thermocouple wires. (3) Of the two tolerance values in the same column, the larger one shall be used.

## 金属保护管材料 Metal protection tube material

代号 Code	材料种类 ( 牌号/代号 ) Material type ( Brand/Code )		使用最高温度 ( °C ) Maximum application temperature ( °C )		特性 Characteristics
	中国 ( GB ) ( GB ) China	美国 ( ASTM ) ( ASTM ) USA	长期 Long-term	短期 Short-term	
S4	0Cr18Ni9	304	850	900	铬镍合金; 耐热钢, 耐酸、耐碱。不适用于硫磺、还原性气氛。 chrome-nickel alloy; heat-resisting steel, acid proof and alkali proof. Not suitable for sulfur and reducing gas.
L4	00Cr19Ni10	304L	800	900	铬镍合金; 是304的超低碳钢, 由于含碳量低, 耐晶间腐蚀性优越。 chrome-nickel alloy; 304 ultra-low-carbon steel with low carbon content and fine inter-crystalline corrosion resistance.
C5	0Cr25Ni20	310S	1000	1150	高铬镍合金; 耐热性好, 具有良好的抗氧化、抗渗碳性能和机械性能。 High-chrome-nickel alloy with good heat-resistance and fine anti-oxidation, anti-carburization and mechanical property.
S6	0Cr17Ni12Mo2	316	800	900	铬镍合金; 高温中的耐腐蚀性能好, 耐酸、碱、海水与侵蚀性物质。 chrome-nickel alloy with good corrosion proof in high temperature and acid proof, alkali proof and seawater proof properties.
L6	00Cr17Ni14Mo2	316L	800	900	铬镍合金; 超低碳钢, 耐晶间腐蚀好, 抗氧化物。其余性能同316相似。 chrome-nickel alloy; ultra-low-carbon steel with fine inter-crystalline corrosion resistance and anti-oxidation properties. Other properties are same as that of 316.
MT	00Cr18Ni12Mo2Ti	316Ti	800	900	铬镍合金; 耐晶间腐蚀和点蚀的性能优良。耐尿素、稀硫酸等各种有机酸。 chrome-nickel alloy with fine inter-crystalline corrosion resistance and pitting corrosion and good organic acid proof properties, such as carbamide and dilute sulphuric acid.
S9	1Cr18Ni9Ti	321	800	900	铬镍合金; 抗氧化性能良好。对磷酸和稀硝酸和醋酸具有良好的耐蚀性。 chrome-nickel alloy with fine anti-oxidation and good organic acid proof properties, such as phosphoric acid and dilute nitric acid.
Nb	0Cr18Ni11Nb	347	750	870	铬镍合金; 高温强度好, 耐晶间应力腐蚀性良好。耐酸、碱、盐等介质。 chrome-nickel alloy with fine inter-crystalline corrosion resistance in high temperature and good medium proof properties, such as acid, alkali and salt.
N6	1Cr15Ni75Fe8	Inconel600	1050	1250	镍铬铁合金; 最适合高温氧化, 还原性气氛。抗氯离子应力腐蚀能好。 nickel-chromium-iron alloy; especially suitable for high temperature oxidation and reducing gas with good anti-chlorion stress corrosion property.
IN8	0Cr20Ni32AlTi	Inconel800	1100	1100	高镍铁合金; 耐硫、氧化物和熔融的中性盐, 耐二氧化碳的混合气体。 High chromium-iron alloy with good sulfide, cyanide and fusing neutral salt proof and fine mixed gas of carbon dioxide proof properties.
HB	0Ni65Mo28Fe5V	Hastelloy B	500	800	镍铁钼合金; 在沸点下一切浓度和盐酸都有良好的耐蚀性, 耐酸、氢氟酸。 Ferro-nickel-molybdenum alloy with good acid corrosion proof property for hydrochloric acid and hydrofluoric acid.
HC	0Cr15Ni60Mo16W5Fe5	Hastelloy C	1000	1090	镍铬铁钼合金; 耐氧化性硝酸等、高于常温的次氯酸盐溶液等的腐蚀。 Nickel-chromium-iron alloy with good hypochloric acid solution corrosion proof property above the normal temperature, such as oxidized nitric acid.
5M	Ni70Cu28	Monel K500	150	200	镍铜合金; 耐氢氟酸、硫酸、盐酸、抗海水和大多数碱性物质性能优异。 Nickel-copper alloy with fine acid proof, alkali proof and seawater proof properties, such as hydrofluoric acid, sulfuric acid, hydrochloric acid and most alkaline matters.
Ni	Ni9990	Nickel 201	150	200	耐浓碱 ( 纯碱、烧碱 ) 腐蚀特别优异, 中性和微酸性溶液以及有机溶剂。 with special fine concentrated base proof (soda and sodium hydroxide), neutral solution, sub-acid solution and organic solvent proof properties.
Ti	TA(1~3)	Grade(1~3)	150	200	耐湿氯气, 浓硝酸。抗对含Co2的海水、海生物、海洋大气的腐蚀。 with fine wet chlorine gas, aquafortis proof and anti-seawater with Co2, marine growth and marine atmosphere prosperities.
G3	GH3030	-	1050	1125	镍基高温合金; 高温下具有良好的力学性能、抗氧化和抗热腐蚀性能。 Ni-base superalloy with fine mechanical property, oxidation resistance and anti-hot corrosion in high temperature.
G9	GH3039	-	1100	1200	镍基高温合金; 高温下抗氧化能力强、足够的持久强度和冷热疲劳性能。 Ni-base superalloy with fine oxidation resistance and long time strength and thermal fatigue behavior.

## 非金属保护管材料 Material of nonmetal protection tube

代号 Code	材料种类 (成份/代号) Type of material (constitution/symbol)	使用最高温度 (°C) Highest application temperature (°C)		特性 Characteristics
		长期 Long term	短期 Short term	
SO	石英 (SiO <sub>2</sub> ) Quartz	1000	1100	耐高温、膨胀系数低, 耐热震性、化学稳定性和电绝缘性能好, 急冷, 急热强度差。 high temperature resistant, lower coefficient of expansion, good chemical stability and electric insulativity, poor rapid cooling and heating strength.
F4	聚四氟乙烯 (PIFE) Polytetrafluoroethylene	250	280	具有优异的化学稳定性和力学强度, 广泛适用于各种腐蚀介质的温度测量。 excellent chemical stability and mechanical strength, widely applicable to measuring temperatures for corrosive mediums.
F46	聚全氟乙丙烯 (FEP) Fluorinated Ethylene Propylene	200	230	具有F4优良的耐腐蚀化学稳定性, 冲击性能特好, 成型好, 熔融粘接好。 excellent corrosion-proof chemical stability of F4, good impact property, good formability and fine molten adhesion.
A8	高铝质 (85%~90%Al <sub>2</sub> O <sub>3</sub> ) High aluminum texture	1500	1600	有耐高温剧变性能。气密性好, 化学性稳定, 高温下绝缘良好。急冷, 急热强度差。 resistant to high-temperature change, good airtightness, stable chemistry, fine insulation under high temperature, poor rapid cooling and heating strength.
A9	刚玉质 (99%Al <sub>2</sub> O <sub>3</sub> ) Corundum texture	1600	1700	有耐高温剧变性能。气密性良好, 化学性稳定, 高温下绝缘良好。急冷, 急热强度差。 resistant to high-temperature change, good airtightness, stable chemistry, fine insulation under high temperature, poor rapid cooling and heating strength.
SN	氮化硅 (Si <sub>3</sub> N <sub>4</sub> ) Silicon nitride	1000	1100	在高温下具有较好的抗铝液的冲刷能力, 机械性能好, 适用于铝液的温度测量。 good anti-scour to aluminium pad under high temperature, good mechanical properties, applicable to measuring the temperature of aluminium pad.
SC	碳化硅 (99%SiC) Silicon carbide	1600	1650	耐火度和硬度很高。导热性、热膨胀、耐压性以及导电性等方面具有优势。 high refractoriness and hardness, dominant heat conductivity, thermal expansion, pressure resistance and conductivity.
MS	二硅化钼 (MoSi <sub>2</sub> ) Molybdenum disilicide	1600	1700	高温抗氧化性优良。抗腐蚀性、热稳定性、气密性良好。具有耐高温剧变的性能。 fine antioxygenic property under high temperature, good corrosion resistance, thermal stability and airtightness, resistant to high-temperature change.

## 陶瓷保护管直径和长度规格

## Diameter and length specification of porcelain protection tube

直径 Diameter	长度规格L × I Length specification									
	φ16 (单套管) single shell-tube	总长度 L Total length	300	350	400	450	550	650	900	1150
插入长度 I insertion length		150	200	250	300	400	500	750	1000	1500
φ20 (单套管) single shell-tube	总长度 L Total length	-	-	400	450	550	650	900	1150	1650
	插入长度 I insertion length	-	-	250	300	400	500	750	1000	1500
φ25 (双层套管) double shell-tube	总长度 L Total length	-	-	-	-	550	650	900	1150	1650
	插入长度 I insertion length	-	-	-	-	400	500	750	1000	1500

## 型号命名Type designation

温度仪表 Temperature instrument	R	□	热电偶材料 Thermocouple material	R: 铂铑30-铂铑6 Platinum-rhodium30-- Platinum-rhodium6
		□		P: 铂铑10-铂 Platinum-chromium10--chrominum
		□		Q: 铂铑13-铂 Platinum-rhodium13-Platinum-rhodium
		□		N: 镍铬-镍硅 Nickel-chromium--nisioly
		□		M: 镍铬硅-镍硅镁 Nickel-chromium-silicon--nickel-chromium-magnesium
热电偶 Thermocouple	□	□	热电偶支数 Thermocouple number	E: 镍铬-铜镍 Nickel-chromium--cupronickel
		□		J: 铁-铜镍 Ferrum-- cupronickel
		□		T: 铜-铜镍 Copper-- cupronickel
		□		空缺: 单支 Vacancy: single
		□		2: 双支 2: Double
安装固定式 fixing means	□	□	安装固定式 fixing means	3: 叁支 3: Triple
		□		1: 无固定装置式 Non-fixing means
		□		2: 固定螺栓式 fixed bolt
		□		3: 活动法兰式 Flexible flange
		□		4: 固定法兰式 Fixed flange
接线盒型式 Wiring box	□	□	接线盒型式 Wiring box	5: 活动法兰角尺式 Movable flange L-square
		□		6: 固定螺栓锥形保护管式 Fixed bolt taper protection tube
		□		7: 活动螺栓式 Movable bolt
		□		3: 防水式接线盒 Water-proof connection box
		□		4: 防爆型接线盒 Explosion-proof connection box
保护管直径 Diameter of protection tube	□	□	保护管直径 Diameter of protection tube	0: $\phi$ 16mm 保护管 Metal protection tube
		□		1: $\phi$ 20mm 金属保护管 Metal protection tube
		□		2: $\phi$ 16mm 瓷保护管 Pottery protection tube
		□		3: $\phi$ 20mm 瓷保护管 Pottery protection tube
		□		1: $\phi$ 25mm 瓷保护管 (适用铂铑类) Pottery protection tube
固定型式尺寸 Fixing dimension	□	□	固定型式尺寸 Fixing dimension	空缺: 公制螺丝 Vacancy: Metric thread
		□		A: 英制螺丝 British system thread
		□		空缺: (JB/T) 标准法兰 Vacancy: (JB/T) standard flange
		□		A: (ANSI) 标准法兰 (ANSI) standard flange
		□		空缺: 普通型元件 Vacancy: General element
内芯结构 Inner core structure	□	□	内芯结构 Inner core structure	(K): 铠装型元件 (K): Sheathed element

## 简易式铂铑热电偶 Simple type platinum-rhodium thermocouple Simple Type PtRh TC

型号 Model	分度号 Graduation Mark	测量范围 ( $^{\circ}$ C) Measuring Range( $^{\circ}$ C)	热相应时间 $\tau$ 0.5(s) Thermal Response Time $\tau$ 0.5(s)	保护管材料 Protection Tube Material	规格 (mm) Specification	
					d	L
WRR-010 WRR <sub>2</sub> -010	B	0~1600	$\leq 2$	刚玉质 Corundum	$\phi 8$	320 670
WRQ-010 WRQ <sub>2</sub> -010	R	0~1300				370 920
WRP-010 WRP <sub>2</sub> -010	S	0~1300				420 1170 470 1670 520 2170 570



注: 贵金属热电偶丝直径为:  $\phi 0.5\text{mm}$ 。 Note: The diameter of noble metal thermocouple wires is  $\phi 0.5\text{mm}$

## 简易式热电偶(普通型) Simple type thermocouple (conventional type)

型号 Model	分度号 Graduation Mark	测量范围 ( $^{\circ}$ C) Measuring Range( $^{\circ}$ C)	热相应时间 $\tau$ 0.5(s) Thermal Response Time $\tau$ 0.5(s)	保护管材料 Protection Tube Material	规格 (mm) Specification
					L
WRN-010 WRN <sub>2</sub> -010	K	0~1000	$\leq 2 \sim \leq 5$	高铝质 High Al <sub>2</sub> O <sub>3</sub>	320 670
WRE-010 WRE <sub>2</sub> -010	E	0~600			370 920
					420 1170 470 1670 520 2170 570

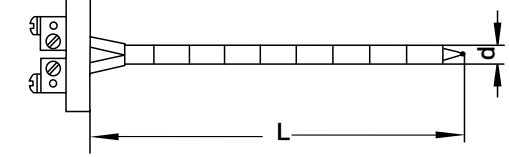

注: 廉金属热电偶丝直径为:  $\phi 1.2\text{mm} \sim 3.2\text{mm}$ 。 Note: The diameter of base metal thermocouple is  $\phi 1.2\text{mm} \sim 3.2\text{mm}$ 。



## 小型铂铑热电偶 Small-sized platinum-rhodium thermocouple

型号 Model	分度号 Graduation Mark	测量范围 (°C) Measuring Range (°C)	热响应时间 $\tau_{0.5(s)}$ Thermal Response Time $\tau_{0.5(s)}$	保护管材料 Protection Tube Material	L(mm)
WRR-100	B	0~1600	≤45	刚玉质 Corundum	225
WRP-100	S	0~1300		高铝质 High Al2O3	
WRQ-100	R	0~1300			



## 无固定装置式热电偶 (瓷保护管) Non-fixed device thermocouple (ceramic protection tube)

热电偶类别 Category	产品型号 Model	分度号 Graduation Mark	测温范围 Measuring Range °C	规格 Specificatio		热响应时间 Thermal Response Time $\tau_{0.5(s)}$
				直径 Diameter mm	保护管材料 Protection tube material	
单支铂铑30-铂铑6 Single rhodium platinum 30- rhodium platinum 6	WRR-130	B	0~1600	φ16	刚玉质 Corundum	≤120
	WRR-131			φ25		≤240
双支铂铑30-铂铑6 Twin rhodium platinum 30- rhodium platinum 6	WRR <sub>2</sub> -130	B	0~1600	φ16	刚玉质 Corundum	≤120
	WRR <sub>2</sub> -131			φ25		≤240
单支铂铑10-铂 Single rhodium platinum 10-platinum	WRP-130	S	0~1300	φ16	高铝质 High Al2O3	≤120
	WRP-131			φ25		≤240
双支铂铑10-铂 Twin rhodium platinum 10-Platinum	WRP <sub>2</sub> -130	S	0~1300	φ16	高铝质 High Al2O3	≤120
	WRP <sub>2</sub> -131			φ25		≤240
单支铂铑13-铂 Single rhodium platinum 10-platinum	WRQ-130	R	0~1300	φ16	高铝质 High Al2O3	≤120
	WRQ-131			φ25		≤240
双支铂铑13-铂 Twin rhodium platinum 10-Platinum	WRQ <sub>2</sub> -130	R	0~1300	φ16	高铝质 High Al2O3	≤120
	WRQ <sub>2</sub> -131			φ25		≤240
单支镍铬-镍硅 Single nickel- chromium-nisiloy	WRN-132	K	0~1100	φ16	高铝质 High Al2O3	≤120
	WRN-133		0~1200	φ20		≤160
双支镍铬-镍硅 Twin nickel- chromium-nisiloy	WRN <sub>2</sub> -132	K	0~1100	φ16	高铝质 High Al2O3	≤120
	WRN <sub>2</sub> -133		0~1200	φ20		≤160
单支镍铬硅-镍硅 Single nickel- chromium-nisiloy	WRM-132	N	0~1100	φ16	高铝质 High Al2O3	≤120
	WRM-133		0~1200	φ20		≤160
双支镍铬硅-镍硅 Twin nickel- chromium-nisiloy	WRM <sub>2</sub> -132	N	0~1100	φ16	高铝质 High Al2O3	≤120
	WRM <sub>2</sub> -133		0~1200	φ20		≤160

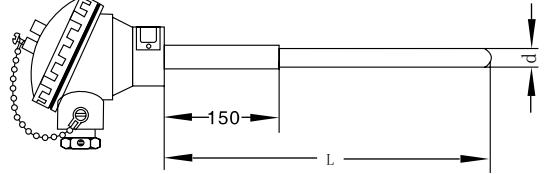

(2) 直径φ25mm为双层瓷套管。

(3) 打“\*”分度号作特殊规格订货。

Note: (1) Refer to Page 6, Table 5 for length specification. Non-placed part is of carbon steel 20 # or stainless steel.

(2) Diameter φ25mm is of two-layer porcelain bushing.

(3) That of “\*” is the order of special specification.

## WRQ-230系列固定螺纹式铂铑热电偶

热电偶类别 Category	产品型号 Model	分度号 Graduation Mark	测温范围 Measuring Range °C	规格Specificatio		热响应时间 Thermal Response Time $\tau \leq 0.5(s)$
				直径 Diameter mm	保护管材料 Protection tube material	
单支铂铑30-铂铑6 Single rhodium platinum 30- rhodium platinum 6	WRR-230	B	0~1600	φ16	刚玉质 Corundum	≤120
	WRR-231			φ25		≤240
双支铂铑30-铂铑6 Twin rhodium platinum 30- rhodium platinum 6	WRR <sub>2</sub> -230			φ16		≤120
	WRR <sub>2</sub> -231			φ25		≤240
单支铂铑10-铂 Single rhodium platinum 10-platinum	WRP-230	S	0~1300	φ16	高铝质 High Al <sub>2</sub> O <sub>3</sub>	≤120
	WRP-231			φ25		≤240
双支铂铑10-铂 Twin rhodium platinum 10-Platinum	WRP <sub>2</sub> -230			φ16		≤120
	WRP <sub>2</sub> -231			φ25		≤240
单支铂铑13-铂 Single rhodium platinum 10-platinum	WRQ-230	R	0~1300	φ16	高铝质 High Al <sub>2</sub> O <sub>3</sub>	≤120
	WRQ-231			φ25		≤240
双支铂铑13-铂 Twin rhodium platinum 10-Platinum	WRQ <sub>2</sub> -230			φ16		≤120
	WRQ <sub>2</sub> -231			φ25		≤240
单支镍铬-镍硅 Single nickel- chromium-nisiloy	WRN-232	K	0~1100	φ16	高铝质High Al <sub>2</sub> O <sub>3</sub>	≤120
	WRN-233		0~1200	φ20		≤160
双支镍铬-镍硅 Twin nickel- chromium-nisiloy	WRN <sub>2</sub> -232		0~1100	φ16		≤120
	WRN <sub>2</sub> -233		0~1200	φ20		≤160
单支镍铬硅-镍硅镁 Single nickel- chromium-nisiloy	WRM-232	N	0~1100	φ16	高铝质High Al <sub>2</sub> O <sub>3</sub>	≤120
	WRM-233		0~1200	φ20		≤160
双支镍铬硅-镍硅镁 Twin nickel- chromium-nisiloy	WRM <sub>2</sub> -232		0~1100	φ16		≤120
	WRM <sub>2</sub> -233		0~1200	φ20		≤160

可以根据用户的要求  
为你量身定制长度和尺寸  
交货速度快

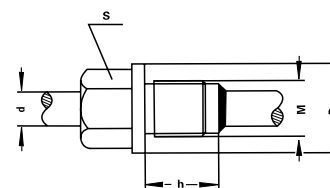
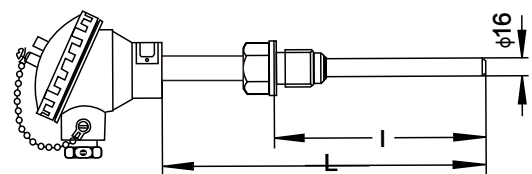

(2) 直径φ25mm为双层瓷套管。

(3) 打“\*”分度号作特殊规格订货。

Note: (1) Refer to Page 6, Table 5 for length specification. Non-placed part is of carbon steel 20 # or stainless steel.

(2) Diameter φ25mm is of two-layer porcelain bushing.

(3) That of “\*” is the order of special specification.

## 常用保护管长度规格

总长L(mm)	225	250	300	350	400	450	550	650	900	1150	1400	1650	2150
置入深度l (mm)	75	100	150	200	250	300	400	500	750	1000	1250	1500	2000

## WRQ-330系列固定螺纹式铂铑热电偶

热电偶类别 Category	产品型号 Model	分度号 Graduation Mark	测温范围 Measuring Range ℃	规格Specificatio		热响应时间 Thermal Response Time $\tau \leq 0.5(s)$
				直径 Diameter mm	保护管材料 Protection tube material	
单支铂铑30-铂铑6 Single rhodium platinum 30- rhodium platinum 6	WRR-330	B	0~1600	φ16	刚玉质 Corundum	≤120
	WRR-331			φ25		≤240
双支铂铑30-铂铑6 Twin rhodium platinum 30- rhodium platinum 6	WRR <sub>2</sub> -330			φ16		≤120
	WRR <sub>2</sub> -331			φ25		≤240
单支铂铑10-铂 Single rhodium platinum 10-platinum	WRP-330	S	0~1300	φ16	高铝质 High Al <sub>2</sub> O <sub>3</sub>	≤120
	WRP-331			φ25		≤240
双支铂铑10-铂 Twin rhodium platinum 10-Platinum	WRP <sub>2</sub> -330			φ16		≤120
	WRP <sub>2</sub> -331			φ25		≤240
单支铂铑13-铂 Single rhodium platinum 10-platinum	WRQ-330	R	0~1300	φ16	高铝质 High Al <sub>2</sub> O <sub>3</sub>	≤120
	WRQ-331			φ25		≤240
双支铂铑13-铂 Twin rhodium platinum 10-Platinum	WRQ <sub>2</sub> -330			φ16		≤120
	WRQ <sub>2</sub> -331			φ25		≤240
单支镍铬-镍硅 Single nickel- chromium-nisiloy	WRN-332	K	0~1100	φ16	高铝质High Al <sub>2</sub> O <sub>3</sub>	≤120
	WRN-333		0~1200	φ20		≤160
双支镍铬-镍硅 Twin nickel- chromium-nisiloy	WRN <sub>2</sub> -332		0~1100	φ16		≤120
	WRN <sub>2</sub> -333		0~1200	φ20		≤160
单支镍铬硅-镍硅镁 Single nickel- chromium-nisiloy	WRM-332	N	0~1100	φ16	高铝质High Al <sub>2</sub> O <sub>3</sub>	≤120
	WRM-333		0~1200	φ20		≤160
双支镍铬硅-镍硅镁 Twin nickel- chromium-nisiloy	WRM <sub>2</sub> -332		0~1100	φ16		≤120
	WRM <sub>2</sub> -333		0~1200	φ20		≤160

可以根据用户的要求  
为你量身定制长度和尺寸  
交货速度快

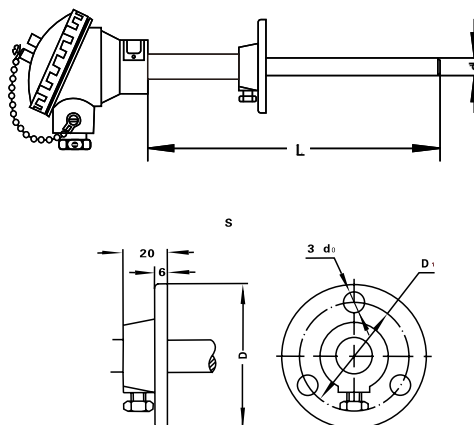

(2) 直径φ25mm为双层瓷套管。

(3) 打“\*”分度号作特殊规格订货。

Note: (1) Refer to Page 6, Table 5 for length specification. Non-placed part is of carbon steel 20# or stainless steel.

(2) Diameter φ25mm is of two-layer porcelain bushing.

(3) That of “\*” is the order of special specification.

## 常用保护管长度规格

总长L(mm)	225	250	300	350	400	450	550	650	900	1150	1400	1650	2150
置入深度l (mm)	75	100	150	200	250	300	400	500	750	1000	1250	1500	2000

## WR□-430系列固定螺纹式铂铑热电偶

热电偶类别 Category	产品型号 Model	分度号 Graduation Mark	测温范围 Measuring Range °C	规格Specificatio		热响应时间 Thermal Response Time τ 0.5(s)	
				直径 Diameter mm	保护管材料 Protection tube material		
单支铂铑30-铂铑6 Single rhodium platinum 30- rhodium platinum 6	WRR-430	B	0~1600	φ16	刚玉质 Corundum	≤120	
	WRR-431			φ25		≤240	
	双支铂铑30-铂铑6 Twin rhodium platinum 30- rhodium platinum 6			WRR <sub>2</sub> -430		φ16	≤120
				WRR <sub>2</sub> -431		φ25	≤240
单支铂铑10-铂 Single rhodium platinum 10-platinum	WRP-430	S	0~1300	φ16	高铝质 High Al <sub>2</sub> O <sub>3</sub>	≤120	
	WRP-431			φ25		≤240	
	双支铂铑10-铂 Twin rhodium platinum 10-Platinum			WRP <sub>2</sub> -430		φ16	≤120
				WRP <sub>2</sub> -431		φ25	≤240
单支铂铑13-铂 Single rhodium platinum 10-platinum	WRQ-430	R	0~1300	φ16	高铝质 High Al <sub>2</sub> O <sub>3</sub>	≤120	
	WRQ-431			φ25		≤240	
	双支铂铑13-铂 Twin rhodium platinum 10-Platinum			WRQ <sub>2</sub> -430		φ16	≤120
				WRQ <sub>2</sub> -431		φ25	≤240
单支镍铬-镍硅 Single nickel- chromium-nisiloy	WRN-432	K	0~1100	φ16	高铝质High Al <sub>2</sub> O <sub>3</sub>	≤120	
	WRN-433		0~1200	φ20		≤160	
	双支镍铬-镍硅 Twin nickel- chromium-nisiloy		WRN <sub>2</sub> -432	0~1100		φ16	≤120
			WRN <sub>2</sub> -433	0~1200		φ20	≤160
单支镍铬硅-镍硅镁 Single nickel- chromium-nisiloy	WRM-432	N	0~1100	φ16	高铝质High Al <sub>2</sub> O <sub>3</sub>	≤120	
	WRM-433		0~1200	φ20		≤160	
	双支镍铬硅-镍硅镁 Twin nickel- chromium-nisiloy		WRM <sub>2</sub> -432	0~1100		φ16	≤120
			WRM <sub>2</sub> -433	0~1200		φ20	≤160

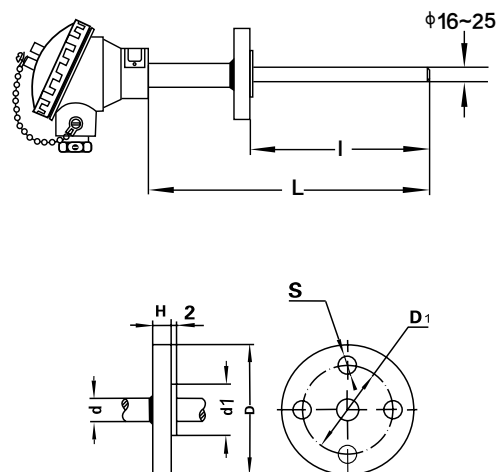

可以根据用户的要求  
为你量身定制长度和尺寸  
交货速度快

(2) 直径φ25mm为双层瓷套管。

(3) 打“\*”分度号作特殊规格订货。

Note: (1) Refer to Page 6, Table 5 for length specification. Non-placed part is of carbon steel 20# or stainless steel.

(2) Diameter φ25mm is of two-layer porcelain bushing.

(3) That of “\*” is the order of special specification.

### 常用保护管长度规格

总长L(mm)	225	250	300	350	400	450	550	650	900	1150	1400	1650	2150
置入深度l (mm)	75	100	150	200	250	300	400	500	750	1000	1250	1500	2000

## 无固定装置式热电偶 (金属保护管) Non-fixed device thermocouple (metal protection tube)

热电偶类别 Category	产品型号 Model	分度号 Graduation Mark	测温范围 Measuring Range °C	保护管材料 Protection tube material	规格 Specification	
					总长 Overall length Lmm	
单支镍铬-镍硅 Single nickel-chromium-nisiloy	WRN-130	K	0~800	1Cr18Ni9Ti	250	300
双支镍铬-镍硅 Twin nickel-chromium-nisiloy	WRN <sub>2</sub> -130			0Cr25Ni20		
单支镍铬-铜镍 Single nickel-chromium-cupronickel	WRE-130	E	0~600	1Cr18Ni9Ti	350	400
双支镍铬-铜镍 Twin nickel-chromium-cupronickel	WRE <sub>2</sub> -130					
单支镍铬硅-镍硅镁 Single nickel-chromium-silicon-nickel-silicon-magnesium	WRM-130	N	0~800	1Cr18Ni9Ti	450	550
双支镍铬硅-镍硅镁 Twin nickel-chromium-silicon-nickel-silicon-magnesium	WRM <sub>2</sub> -130					
单支铁-铜镍 Single ferrum-cupronickel	WRJ-130	J	0~500	1Cr18Ni9Ti	650	900
双支铁-铜镍 Twin ferrum-cupronickel	WRJ <sub>2</sub> -130					
单支铜-铜镍 Single cuprum-cupronickel	WRT-130	T	-40~+350	1Cr18Ni9Ti	1150	1650
双支铜-铜镍 Twin cuprum-cupronickel	WRT <sub>2</sub> -130					



注: (1) 热响应时间  $\tau < 0.5 < 90s$ 。

(2) 保护管材料参见5页。

(3) 打“\*”分度号作特殊规格订货。

(4) 保护管选用0Cr25Ni20, 型号后面加“H”, 例: WRN-130H。

Note: (1) Thermal Response Time  $\tau < 0.5(s)$  is less than 90s.

(2) Refer to page 5, table 3 for protection tube material.

(3) That of “\*” is the order of special specification.

(4) The protection tube shall use 0Cr25Ni20, and be remarked a “H” be hind the model, for example WRN-130H.

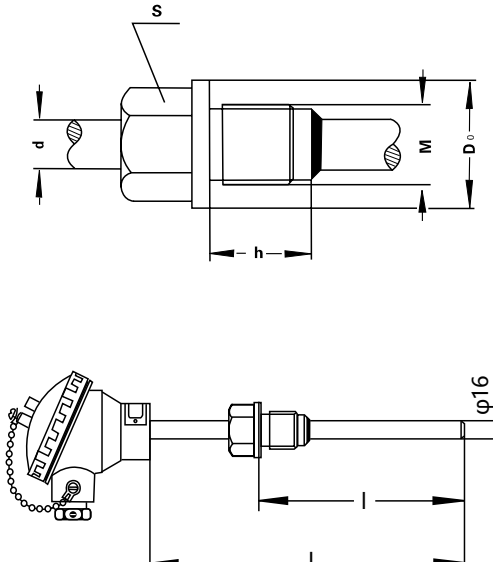

## 固定螺栓式热电偶 Fixed bolt thermocouple

热电偶类别 Category	产品型号 Model	分度号 Graduation Mark	测量范围 (°C) Measuring Range (°C)	热响应时间 $\tau_{0.5}(s)$ Thermal Response Time $\tau_{0.5}(s)$	保护管材料 Protection Tube Material	规格 Specification																					
						L × I																					
单支铂铑30 - 铂铑6 Single rhodium platinum 30-rhodium platinum 6	WRR-230	B	0~1600	≤120	钢玉质 Corundum	250 × 100	<table border="1"> <tr> <td>d</td> <td>M</td> <td>h</td> <td>s</td> <td>D0</td> <td>公称压力 Nominal pressure</td> </tr> <tr> <td>φ10</td> <td rowspan="3">M27×2 G3/4"</td> <td rowspan="3">32</td> <td rowspan="3">32</td> <td rowspan="3">φ40</td> <td rowspan="3">10 Mpa</td> </tr> <tr> <td>φ12</td> </tr> <tr> <td>φ16</td> </tr> <tr> <td>φ20</td> <td>M33×2 G1"</td> <td>35</td> <td>36</td> <td>φ48</td> <td></td> </tr> </table>	d	M	h	s	D0	公称压力 Nominal pressure	φ10	M27×2 G3/4"	32	32	φ40	10 Mpa	φ12	φ16	φ20	M33×2 G1"	35	36	φ48	
d	M					h		s	D0	公称压力 Nominal pressure																	
φ10	M27×2 G3/4"	32	32	φ40	10 Mpa																						
φ12																											
φ16																											
φ20	M33×2 G1"	35	36	φ48																							
双支铂铑30 - 铂铑6 Twin rhodium platinum 30-rhodium platinum 6	WRR <sub>2</sub> -230	300 × 150																									
单支铂铑10 - 铂 Single rhodium platinum 10-platinum	WRP-230	S	0~1300			350 × 200																					
双支铂铑10 - 铂 Single rhodium platinum 10-platinum	WRP <sub>2</sub> -230					400 × 250																					
单支镍铬 - 镍硅 Single nickel-chromium-nisiloy	WRN-232	K	0~1100		高铝质 High Al2O3 Ceramic	450 × 300																					
双支镍铬 - 镍硅 Twin nickel-chromium-nisiloy	WRN <sub>2</sub> -232					550 × 400																					
单支镍铬 - 镍硅 Single nickel-chromium-nisiloy	WRN-233					650 × 500																					
双支镍铬 - 镍硅 Twin nickel-chromium-nisiloy	WRN <sub>2</sub> -233					900 × 750																					
单支镍铬硅 - 镍硅镁 Single nickel-chromium-silicon-nickel-silicon-magnesium	WRM-232	N	0~1200	≤90		1150 × 1000																					
双支镍铬硅 - 镍硅镁 Twin nickel-chromium-silicon-nickel-silicon-magnesium	WRM <sub>2</sub> -232					1650 × 1500																					
单支镍铬硅 - 镍硅镁 Single nickel-chromium-silicon-nickel-silicon-magnesium	WRM-233					2150 × 2000																					
双支镍铬硅 - 镍硅镁 Twin nickel-chromium-silicon-nickel-silicon-magnesium	WRM <sub>2</sub> -233																										
单支镍铬 - 镍硅 Single nickel-chromium-nisiloy	WRN-230	K	0~1000		1Cr18Ni9Ti 0Cr25Ni20																						
双支镍铬 - 镍硅 Twin nickel-chromium-nisiloy	WRN <sub>2</sub> -230																										
单支镍铬 - 铜镍 Single nickel-chromium-cupronickel	WRE-230	E	0~600		1Cr18Ni9Ti																						
双支镍铬 - 铜镍 Twin nickel-chromium-cupronickel	WRE <sub>2</sub> -230																										
单支铁 - 铜镍 Single ferrum-cupronickel	WRJ-230	J	0~500		1Cr18Ni9Ti																						
双支铁 - 铜镍 Twin ferrum-cupronickel	WRJ <sub>2</sub> -230																										

- 注： (1) 保护管材料参见第5页，长度参见第6页。  
(2) 打 “\*” 分度号作特殊规格订货。  
(3) 公称压力：10MPa。  
(4) 型号后加 (K)，内芯元件为铠装元件。例：WRN-230 (K)。

- Note: (1) Refer to page 5, and page 6, for protection tube material.  
(2) That of “\*” is the order of special specification.  
(3) Nominal pressure is 10MPa.  
(4) Model with suffix (K), its inner core is sheathed element. For example WRN-230 (K).

## 活动法兰式热电偶 Flexible flange thermocouple

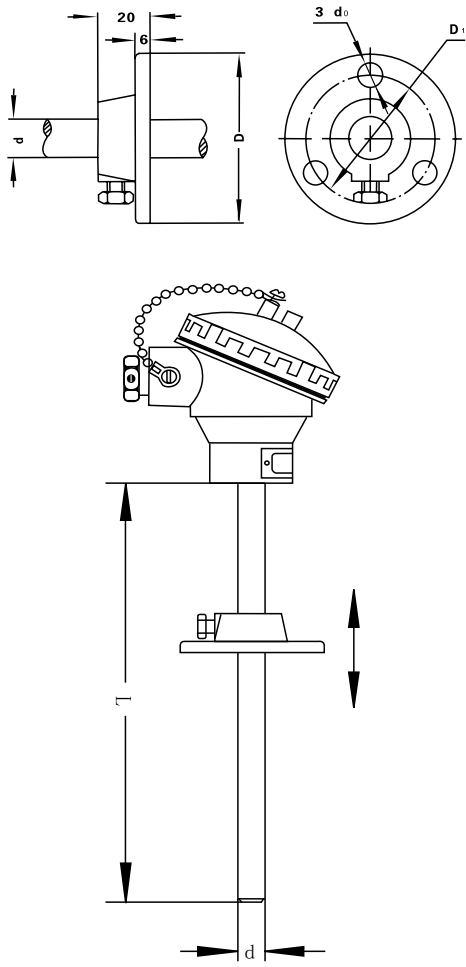
热电偶类别 Category	产品型号 Model	分度号 Graduation Mark	测量范围 (°C) Measuring Range(°C)	热响应时间 $\tau_{0.5(s)}$ Thermal Response Time $\tau_{0.5(s)}$	保护管材料 Protection Tube Material	规格 Specification					
						L × I					
单支铂铑30-铂铑6 Single rhodium platinum 30-rhodium platinum 6	WRR-330	B	0~1600	≤120	钢玉质 Corundum	250×100	d	D	D1	d0	公称压力 Nominal pressure
双支铂铑30-铂铑6 Twin rhodium platinum 30-rhodium platinum 6	WRR <sub>2</sub> -330					300×150					
单支铂铑10-铂 Single rhodium platinum 10-platinum	WRP-330	S	0~1300	≤120	高铝质 High Al <sub>2</sub> O <sub>3</sub> Ceramic	350×200	d	D	D1	d0	公称压力 Nominal pressure
双支铂铑10-铂 Single rhodium platinum 10-platinum	WRP <sub>2</sub> -330					400×250					
单支镍铬-镍硅 Single nickel-chromium-nisiloy	WRN-332	K	0~1100	≤120	高铝质 High Al <sub>2</sub> O <sub>3</sub> Ceramic	450×300	d	D	D1	d0	公称压力 Nominal pressure
双支镍铬-镍硅 Twin nickel-chromium-nisiloy	WRN <sub>2</sub> -332					550×400					
单支镍铬-镍硅 Single nickel-chromium-nisiloy	WRN-333	K	0~1100	≤120	高铝质 High Al <sub>2</sub> O <sub>3</sub> Ceramic	650×500	d	D	D1	d0	公称压力 Nominal pressure
双支镍铬-镍硅 Twin nickel-chromium-nisiloy	WRN <sub>2</sub> -333					900×750					
单支镍铬硅-镍硅镁 Single nickel-chromium-silicon-nickel-silicon-magnesium	WRM-332	N	0~1200	≤90	高铝质 High Al <sub>2</sub> O <sub>3</sub> Ceramic	1150×1000	d	D	D1	d0	公称压力 Nominal pressure
双支镍铬硅-镍硅镁 Twin nickel-chromium-silicon-nickel-silicon-magnesium	WRM <sub>2</sub> -332					1650×1500					
单支镍铬硅-镍硅镁 Single nickel-chromium-silicon-nickel-silicon-magnesium	WRM-333	N	0~1200	≤90	高铝质 High Al <sub>2</sub> O <sub>3</sub> Ceramic	900×750	d	D	D1	d0	公称压力 Nominal pressure
双支镍铬硅-镍硅镁 Twin nickel-chromium-silicon-nickel-silicon-magnesium	WRM <sub>2</sub> -333					1150×1000					
单支镍铬-镍硅 Single nickel-chromium-nisiloy	WRN-330	K (EU-2)*	0~1000	≤120	1Cr18Ni9Ti 0Cr25Ni20	1150×1000	d	D	D1	d0	公称压力 Nominal pressure
双支镍铬-镍硅 Twin nickel-chromium-nisiloy	WRN <sub>2</sub> -330					1650×1500					
单支镍铬-铜镍 Single nickel-chromium-cupronickel	WRE-330	E (EA-2)*	0~600	≤120	1Cr18Ni9Ti	2150×2000	d	D	D1	d0	常压 Normal pressure
双支镍铬-铜镍 Twin nickel-chromium-	WRE <sub>2</sub> -330					2150×2000					

(1) 打“\*”分度号作特殊规格订货。

(2) 型号后加(K), 内芯为铠装元件。例: WRN-330(K)。

(1) That of “\*” is the order of special specification.

(2) Model with suffix (K), its inner core is sheathed element. For example WRN-330 (K).

## 固定法兰式热电偶 Fixed flange thermocouple

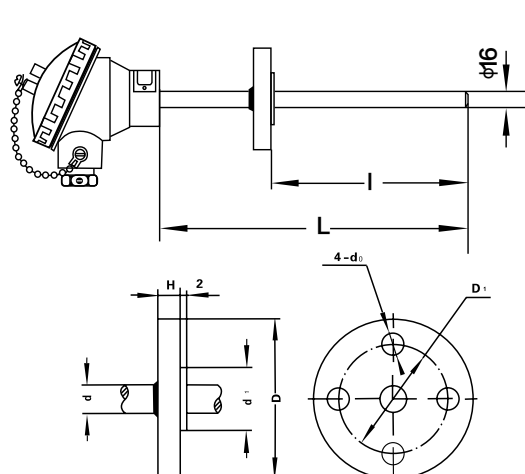
热电偶类别 Category	产品型号 Model	分度号 Graduation Mark	测量范围 (°C) Measuring Range(°C)	热响应时间 $\tau_{0.5(s)}$ Thermal Response Time $\tau_{0.5(s)}$	保护管材料 Protection Tube Material	规格 Specification															
						L × I															
单支镍铬-镍硅 Single nickel-chromium-nisiloy	WRN-430	K	0~800	$\leq 90$	1Cr18Ni9Ti	250×100	<table border="1"> <tr> <td>d</td> <td>D</td> <td>D1</td> <td>d1</td> <td>H</td> <td>d0</td> <td rowspan="2">公称压力 Nominal pressure</td> </tr> <tr> <td><math>\phi 8</math> <math>\phi 10</math></td> <td><math>\phi 95</math></td> <td><math>\phi 65</math></td> <td><math>\phi 45</math></td> <td>16</td> <td><math>\phi 14</math></td> <td rowspan="2">2.5 Mpa</td> </tr> </table>	d	D	D1	d1	H	d0	公称压力 Nominal pressure	$\phi 8$ $\phi 10$	$\phi 95$	$\phi 65$	$\phi 45$	16	$\phi 14$	2.5 Mpa
d	D		D1		d1	H		d0	公称压力 Nominal pressure												
$\phi 8$ $\phi 10$	$\phi 95$	$\phi 65$	$\phi 45$		16	$\phi 14$	2.5 Mpa														
双支镍铬-镍硅 Twin nickel-chromium-nisiloy	WRN <sub>2</sub> -430	0~1000	0Cr25Ni20		300×150																
单支镍铬硅-镍硅镁 Single nickel-chromium-nickel-silicon-magnesium	WRM-430	N	0~800		1Cr18Ni9Ti	350×200															
双支镍铬硅-镍硅镁 Twin nickel-chromium-silicom-nickel-silicon-magnesium	WRM <sub>2</sub> -430		0~1000		0Cr25Ni20	400×250															
单支镍铬-铜镍 Single nickel-chromium-cupronickel	WRE-430	E	0~600		$\leq 90$	1Cr18Ni9Ti	550×400														
双支镍铬-铜镍 Twin nickel-chromium-cupronickel	WRE <sub>2</sub> -332		0~600				650×500														
单支铁-铜镍 Single ferrum-cupronickel	WRJ-430	J	0~500				900×750														
双支铁-铜镍 Twin ferrum-cupronickel	WEJ <sub>2</sub> -430		0~500				1150×1000														
单支铜-铜镍 Single cuprum-cupronickel	WRT-430	T	-40~+350	1650×1500																	
双支铜-铜镍 Twin cuprum-cupronickel	WRT <sub>2</sub> -430			2150×2000																	

注：(1) 公称压力：2.5MPa。(2) 型号后加(K)，内芯为铠装元件。例：WRN-430(K)。

Note: (1) Normal pressure: 2.5MPa. (2) Model with suffix (K), its inner core is sheathed element. For example WRN-430(K).

## 活动法兰角尺式热电偶 Flexible flange L-square thermocouple

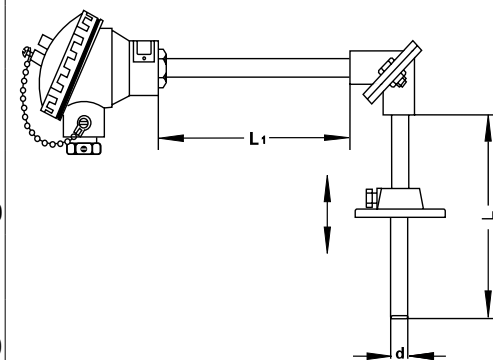
热电偶类别 Category	产品型号 Model	分度号 Graduation Mark	测量范围 (°C) Measuring Range(°C)	热响应时间 $\tau_{0.5(s)}$ Thermal Response Time $\tau_{0.5(s)}$	保护管材料 Protection Tube Material	规格 Specification									
						d	L × I								
单支镍铬-镍硅 Single nickel-chromium-nisiloy	WRN-530	K	0~800	$\leq 90$	1Cr18Ni9Ti 0Cr25Ni20	$\phi 16$	500 × 500								
双支镍铬-镍硅 Twin nickel-chromium-nisiloy	WRN <sub>2</sub> -530		0~1000												
单支镍铬硅-镍硅镁 Single nickel-chromium-nickel-silicon-magnesium	WRM-530	N	0~800				750 × 750								
双支镍铬硅-镍硅镁 Twin nickel-chromium-nickel-silicon-magnesium	WRM <sub>2</sub> -530		0~1000				1000 × 500								
单支镍铬-铜镍 Single nickel-chromium-cupronickel	WRE-530	E	0~600				$\leq 120$	刚玉质	$\phi 20$						
双支镍铬-铜镍 Twin nickel-chromium-cupronickel	WRE <sub>2</sub> -530		0~600												
单支铂铑10-铂 Single Rhodium Platinum 10-Platinum	WRP-530	S	0~1300												
双支铂铑10-铂 Twin Rhodium Platinum 10-Platinum	WRP <sub>2</sub> -530		0~1300												

注：(1) 公称压力为常压。(2) 型号后加(K)内芯为铠装元件。例：WRN-530(K)。

Note: Nominal pressure is ordinary pressure. (2) Model with suffix (K), its inner core is sheathed element. For example WRN-530(K).

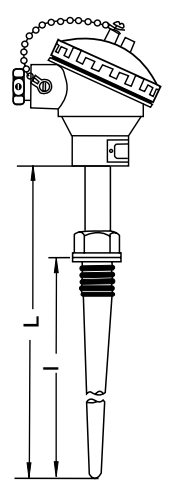

## 固定螺栓锥形保护管热电偶 Fixed bolt taper protection tube thermocouple

热电偶类别 Category	产品型号 Model	分度号 Graduation Mark	测量范围 (°C) Measuring Range(°C)	热响应时间 $\tau_{0.5}(s)$ Thermal Response Time $\tau_{0.5}(s)$	保护管材料 Protection Tube Material	规格 Specification	
						L × I	
单支镍铬-镍硅 Single nickel-chromium-nisiloy 双支镍铬-镍硅 nickel-chromium-nisiloy	WRN-630 (K) WRN <sub>2</sub> -630 (K)	K	0~600	≤45	1Cr18Ni9Ti	225 75	
	WRN-630A(K) WRN <sub>2</sub> -630A(K)					250 ×100	
	WRN-630B(K) WRN <sub>2</sub> -630B(K)					300 ×150	
	WRN-630B(K) WRN <sub>2</sub> -630B(K)					350 ×200	
单支镍铬-铜镍 双支镍铬-铜镍 Single nickel-chromium-cupronickel Twin nickel-chromium-cupronickel	WRE-630(K) WRE <sub>2</sub> -630(K)	E	0~600	≤45	1Cr18Ni9Ti	400 ×250	
	WRE-630A(K) WRE <sub>2</sub> -630A(K)					450 ×300	
	WRE-630B(K) WRE <sub>2</sub> -630B(K)					500 ×350	
	WRE-630B(K) WRE <sub>2</sub> -630B(K)					550 ×400	
						600 ×450	
						650 ×500	

注：(1) 公称压力：30MPa。流速≤80m/s

(2) 选用英制G1”螺栓，内芯铠装元件，应在型号后加A。例如：WRN-630A(K)

(3) 选配齿形垫片，应在型号后加B，例如：WRN-630B(K)。齿形垫片参见93页，图152。

Note: (1) Normal pressure:30MPa. Flow rate≤80m/s.

(2) “A” shall be attached to the model if British system G1” bolt and sheat elements for inner core is selected for use, for example: WRN-630A(K).

(3) When serrated washer is used,B should be added after model, for example: WRN-630B(K). Refer to page 93, Fig 152 for specification of serrated waster.

## 拱顶热电偶 Dome thermocouple

WRP型拱顶热电偶是为了适应高炉拱顶温度的检测，而进行设计制造的新型热电偶。热电偶保护管选用进口Sic再结晶材料能够满足高炉测温的特殊要求。在构造上，有密封、耐震动、可以垂直安装和有快速装卸的法兰结构。

WRP-type dome thermocouple is a new thermocouple designed and manufactured to be adapted to measuring the temperature of the dome of blast furnace. The thermocouple protection tube, made of imported Sic recrystallized material can meet the special requirements that are needed to measure the temperature of blast furnace. For the structure, it has a flange structure which is sealed, and quake-resistant and can be installed vertically and assembled or disassembled quickly.

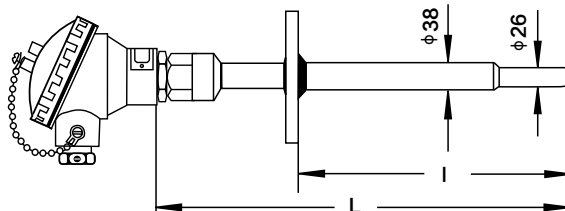

## 主要技术指标 Major technical indexes

分度号: S(铂铑10-铂) Graduation symbol: S (platinum rhodium 10—platinum)

测温范围: 0~1300°C Measuring range: 0~1300°C

公称压力: 0.3MPa Nominal pressure: 0.3MPa

热响应时间:  $\tau < 0.5 < 360S$  Thermal response time:  $\tau < 0.5 < 360S$

允许误差  $\Delta t$ :  $\pm 1.5^\circ C$  或  $0.75 t$  Permissible error  $\Delta t$ :  $\pm 1.5^\circ C$  or  $0.75 t$

规格长度L \*l: 1400×1250、1750×1600mm

Length L \*l: 1400×1250, 1750×1600mm

## 装配式热电偶 热电阻安装示意图

## Scheme of installation of Assembly thermocouple and thermal resistance

a

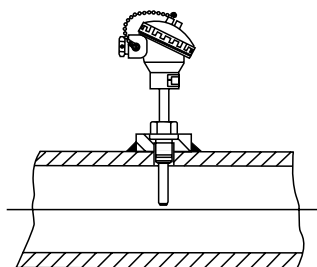

垂直管道轴线的安装方法  
Installation method vertical to pipe axis

b

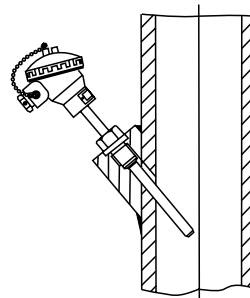

倾斜管道轴线的安装方法  
Installation method slant to pipe axis

c

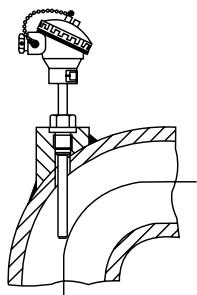

在弯曲管道上的安装方法  
Installation method on curved pipe

d

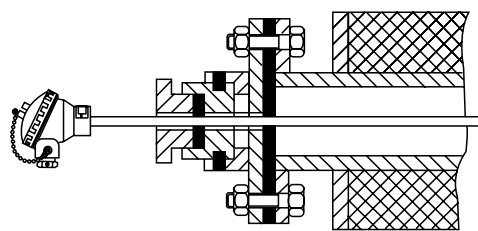

锅炉烟道中的密封安装方法  
Sealed Installation method of boiler chimney